



Announcement no: (IUL)FDC-BD/FDC/2024/13

Date: 29th December 2024

REVISED INVITATION FOR THE SUBMISSION OF EXPRESSION OF INTEREST (EOI)

FOR SUPPLY AND INSTALLATION OF KITCHEN SETS IN FDC SOCIAL HOUSING PROJECT.

This revised announcement supersedes and replaces the previously issued announcement number (IUL)FDC-BD/FDC/2024/9, which has been officially cancelled.

Fahi Dhiriulhun Corporation Limited (FDC) is seeking qualified parties for the supply and installation of Kitchen Sets in our Social Housing project located in Hulhumale' Phase 2. FDC invites all interested parties to submit their Expressions of Interest (EOI) for the supply and installation of Kitchen Sets.

This announcement aims to provide equal opportunities for professional, experienced, and reliable proponents to participate in this project. The selected party will be responsible for ensuring that the Kitchen Set meets the required standards and is installed efficiently and in accordance with project timelines.

If multiple proposals are received, FDC will proceed with the EOI that best aligns with the objectives of the project. The evaluation of EOIs will be based on the proposed business model, experience of the supplier, proposed terms, financial stability, capability, and qualifications.

Parties with a history of abandoning projects at any stage after initiation will not meet the eligibility requirements. Companies currently involved in ongoing litigation with FDC will also be disqualified.

FDC retains the right to accept or reject any proposal and to annul the EOI process, rejecting all proposals at any stage before an agreement is signed, without incurring any liability to the proponents. In such cases, all proponents will be notified, and their proposals will be returned.

The completed document set must be submitted using the prescribed 'Expression of Interest (EOI) Application Form' attached to this announcement.

FDC remains committed to partnering with an entity that upholds the highest standards of quality and reliability, in line with our mission to deliver sustainable and affordable housing solutions.

The EOI shall be submitted via e-mail or to the address provided below, on or before **14:00hrs of 14th January 2025**.

BUSINESS DEVELOPMENT

Fahi Dhiriulhun Corporation Limited
6th Floor, Maldives Post Building 20026,
Boduthakurufaanu Magu,
Malè, Republic of Maldives
Email: business@fdc.mv

EXPRESSION OF INTEREST (EOI) FOR SUPPLY & INSTALLATION OF KITCHEN SET

Announcement Number: (IUL)FDC-BD/FDC/2024/13

Date: 29th December 2024





CONTENTS

1	Project Overview	2
2	Proposal Requirement.....	3
3	Benefit of Selected Proponent	4
4	Evaluation Criteria	5

REQUEST FOR PROPOSAL FOR BUSINESS OPPORTUNITIES IN SOCIAL HOUSING

This document serves as a request for proposal (RFP) to identify qualified Proponents for kitchen set solutions aimed at enhancing the living experience of tenants in our social housing project.

The selected Proponent will be expected to provide three distinct kitchen set options, propose a financing scheme, and outline a revenue-sharing model. This initiative seeks to create a platform for tenants to purchase kitchen sets directly from the Proponent, ensuring a seamless and convenient experience while fostering a mutually beneficial partnership.

1. Project Overview

FDC invites qualified Proponents to participate in the selection process of Proponent to provide kitchen sets for tenants of Social Housing units in Hulhumale' Phase 2. The selected Proponents will be responsible for the supply and installation of essential items such as cabinetry, tabletop, faucet, and backsplash, ensuring that all products meet the required standards.

The goal is to facilitate a seamless service for our tenants to ensure timely delivery, professional setup, and smooth coordination with FDC. FDC aims to collaborate closely with the chosen Proponent as a partner through this process. However, this arrangement's exclusivity will not be limited to the selected Proponent; other related businesses are allowed to explore avenues to promote and sell their products conventionally to the respective tenants of our development.

1.1 Proponents Role

- Provide quality and affordable kitchen set packages tailored to the needs of social housing tenants.
- Offer a range of minimum of **three** distinct kitchen set options to accommodate varying budgets and preferences.
- Propose a financing scheme that allows tenants flexible payment options for purchasing furniture.

1.2 FDC Role

- Conduct a thorough selection and evaluation process to ensure the selected Proponent meets the quality and service requirements to undertake the scope of work mentioned.
- Facilitate a platform for tenants to connect with Proponents, promoting convenience and trust.
- Provide opportunities for Proponents to advertise their product during key events, such as signing ceremonies, enhancing visibility and credibility.

2. Qualification Criteria

- Proponents must have provided similar services to at least 3 clients in the past 5 years.
- Proponents must have licensed professionals in kitchen installation, including electricians, plumbers, and cabinet makers.
- The proponent must submit audited financial statements for the past 3 years.
- The proponent must provide a comprehensive supply and installation service for kitchen sets in the housing project.
- All kitchen sets must meet quality standards and be designed for residential use.



3. Proposal Requirement

3.1 Kitchen Set Options:

- Proponents are required to present **three distinct kitchen set options**. Each option should include:
 - A clear list of all components included in the kitchen set package, specifying the types of cabinets, countertops, and additional elements.
 - Provide images, sketches, or 3D renderings to give a clear visual representation of the proposed kitchen sets.
 - Include detailed specifications such as materials used, dimensions, colors, and any other relevant characteristics. **Must have** components are tabletop with dimensions of 600mm width and 18mm thickness and a sink with dimensions of 820mm x 470mm x 228mm.
 - Provide the price for each kitchen set option, including any additional costs for customization or delivery.

3.2. Business Model

- Proponents must present a clear working model detailing the process and roles between themselves and FDC. This includes:
 - Submit a clear working model detailing the process between the proponent and FDC and the tenant, including roles and responsibilities.
 - Outline the full process from order confirmation to installation completion. Covering interactions between the proponent, FDC and customers.
 - Provide a cost breakdown, including product, labor, installation, and other expenses, with the profit margin and FDC's share clearly indicated.
 - Show the final selling price, including an 8% GST, with a detailed cost breakdown.
 - Include a forecast of anticipated earnings, installations, revenue, and profit for both the Proponent and FDC.
 - Ensure transparent calculations of profit-sharing percentages for FDC and the Proponent.

3.3. Revenue Sharing Scheme

- Proponents should propose a **revenue-sharing scheme** that details how profits will be shared between the Proponent and FDC. This should include:
 - Clearly define the percentage of revenue allocated to FDC and the Proponent. For example, propose a split such as 30% of the total revenue to FDC and 70% to the Proponent. Ensuring the split reflects a fair distribution and aligns with the value provided by both parties.
 - Outline the conditions under which the profit-sharing agreement will be implemented.
 - Specify the terms of the agreement, such as 3 years or 5 years, during which the profit-sharing model will be in effect. Include provisions for renewal or renegotiation at the end of the term, based on mutual agreement and performance outcomes.

3.4 Financing Scheme

- Proposals must include a **financing scheme** that outlines how customers can finance their kitchen set purchases. This should include:
 - Offer clear payment options such as monthly installments, specifying duration of the payment period.
 - Clearly state the applicable interest rates and terms for financing, including the total cost of financing over the payment period.
 - Clearly specify the partner banks available for financing and detail the process customers need to follow to secure the financing.

3.5. Delivery Period

- Indicate the estimated time for the installation of a single kitchen set supply and the number of kitchen sets supplies that can be completed concurrently.
 - Provide a detailed timeline indicating whether the kitchen sets will be delivered immediately after the agreement signing or whether the delivery process will commence post to agreement signing.
 - Specify duration for the supply of kitchen sets to Maldives after the shipping process begins.
 - Outline the duration required to assemble and install the kitchen sets for customers upon arrival.

3.6. Warranty Period

- Offer a minimum 3-month warranty on the kitchen sets from the date of handing over of unit to tenant.
- Clearly define the warranty terms, including what is covered and any conditions.

4. Benefits for Selected Proponent from FDC

The selected Proponent will receive the following benefits:

- Designated floor space from the lease agreement signing venue to acquire customers during the lease agreement signing operations carried out by FDC. Additional provisions for the sales operations for the selected Proponent.
- Facilitation for the installation of kitchen sets prior to tenants occupying the units, ensuring seamless setup and readiness.
- Direct engagement with tenants, ensuring seamless transaction process.
- Comprehensive marketing support, including promotional activities, to boost visibility and reach potential customers.

5. Evaluation Criteria

Proposals will be evaluated based on the following criteria:

- A detailed portfolio of proposed kitchen set packages with specifications and pricing.
- Proposal Completeness
- Supporting Information
- Concept Drawing
- Feasibility and attractiveness of the financing scheme
- A comprehensive revenue-sharing proposal.
- Proponent's experience and reputation in the industry
- Marketing and promotional plans for the signing ceremony and other FDC events.

6. Submission Guidelines

- All proposals must be submitted before **1400hrs, 14th January 2025**. Proposals submitted after the deadline will not be considered.
- Proponents **MUST** fill in the information requested on the expression of interest (EOI) application form attached with this announcement. Incomplete forms/information will be rejected.
- FDC retains the right to accept or reject any proposal and to annul the EOI process, rejecting all proposals at any stage before an agreement is signed, without incurring any liability to the proponents. In such cases, all proponents will be notified, and their proposals will be returned.
- Proponents are requested to submit their proposals via email to business@fdc.mv **OR** physically submit the proposal to the following address:
 - **Fahi Dhiriulhun Corporation Limited**
6th Floor, Maldives Post Building
20026, Boduthakurufaanu Magu Malé, Republic of Maldives
- The proposal should include all necessary documentation to meet the minimum requirements and eligibility criteria outlined above.
- For further details, please contact the FDC Business Development Department at the above email address.

CLIENT:
FAHI DHIRIULHUN CORPORATION

PROJECT:
4000 HOUSING UNITS
KITCHEN LAYOUT

DEVELOPER:

CONSULTANT:

REVISION :

ARCHITECT

ENGINEER

DRAFT BY
ASJAD MOHAMED
CHECKED BY
HUSSAIN AZEEM

STAMP:

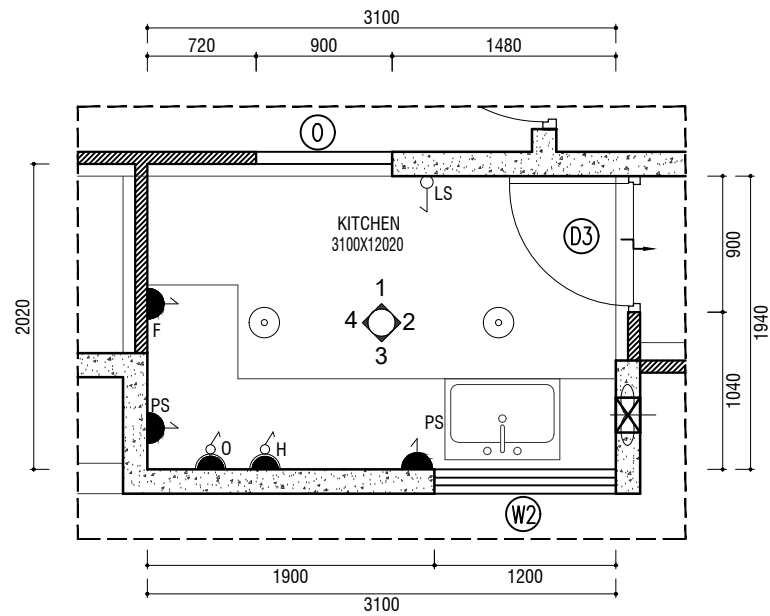

KITCHEN PART PLAN

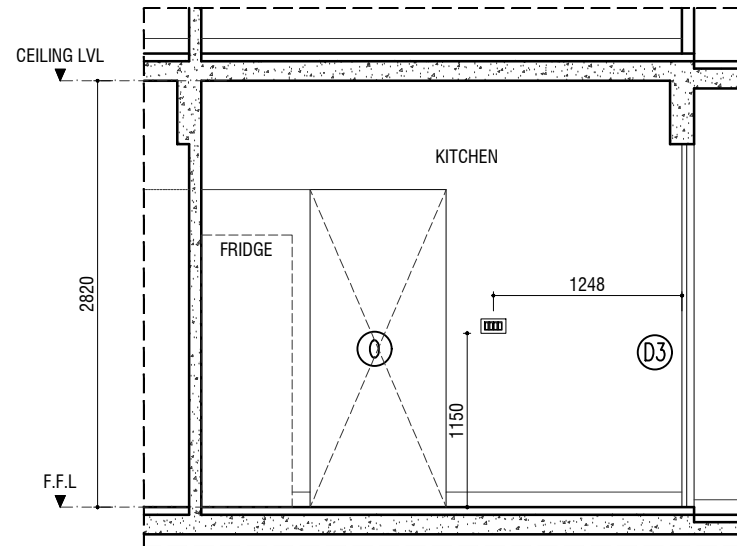

ELEVATION 1

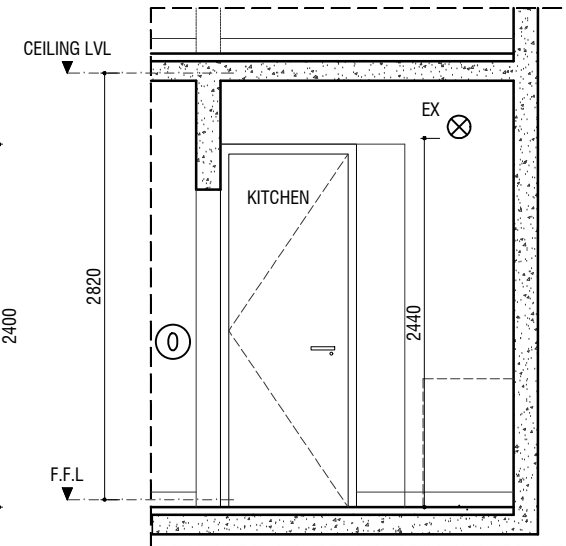

ELEVATION 2

LEGEND		
SYMBOL	DESCRIPTION	MOUNTING HEIGHT
LS	LIGHT SWITCH	1150 mm
PS	13A SWITCH SOCKET- GENERAL PURPOSE	1150 mm
O	16A SWITCH SOCKET - OVEN	450 mm
H	16A SWITCH SOCKET- HOOD	1750 mm
F	13A SWITCH SOCKET - FRIDGE	1150 mm
○	SURFACE MOUNTED LIGHT	-
EX	150mm Ø HOOD EXHAUST	2100 mm

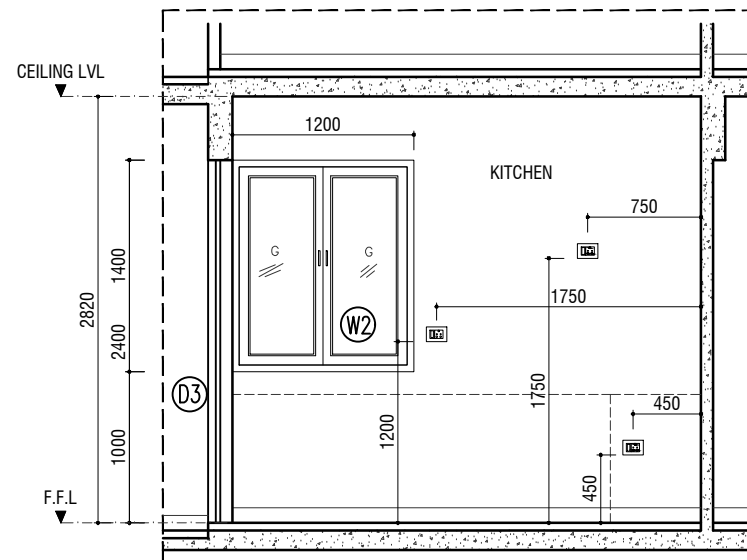

ELEVATION 3

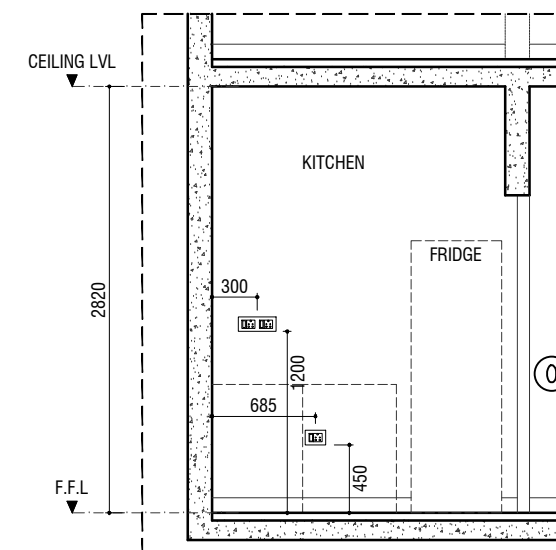

ELEVATION 4

KPIL 3BHK TYPE A KITCHEN LAYOUT

SCALE 1:50



Sheet No.

A-01

1/6

CLIENT:
 FAHI DHIRIULHUN CORPORATION

PROJECT:
 4000 HOUSING UNITS
 KITCHEN LAYOUT

DEVELOPER:

CONSULTANT:

REVISION :

ARCHITECT

ENGINEER

DRAFT BY
 ASJAD MOHAMED
CHECKED BY
 HUSSAIN AZEEM

STAMP:

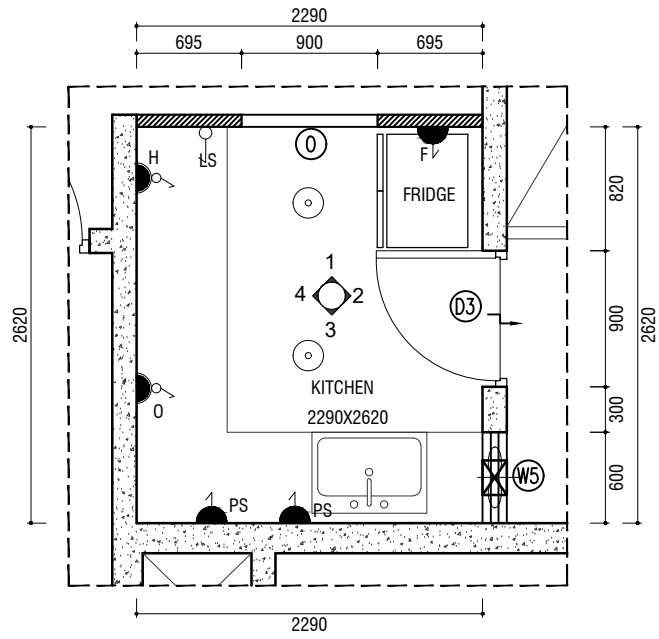

KITCHEN PART PLAN

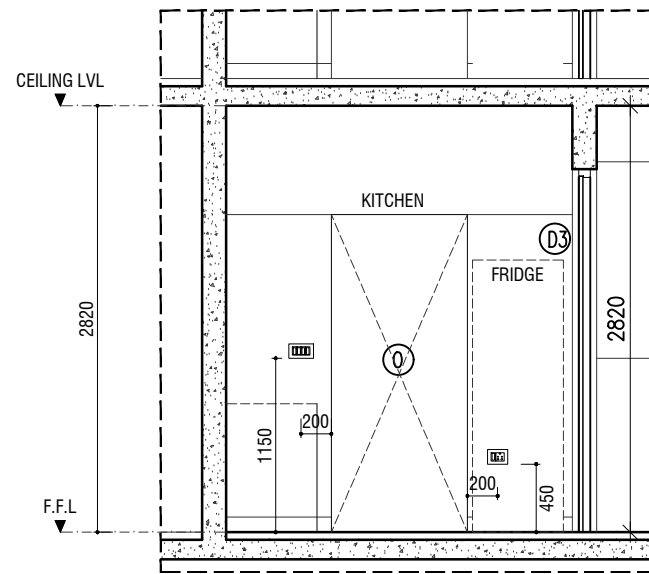

ELEVATION 1

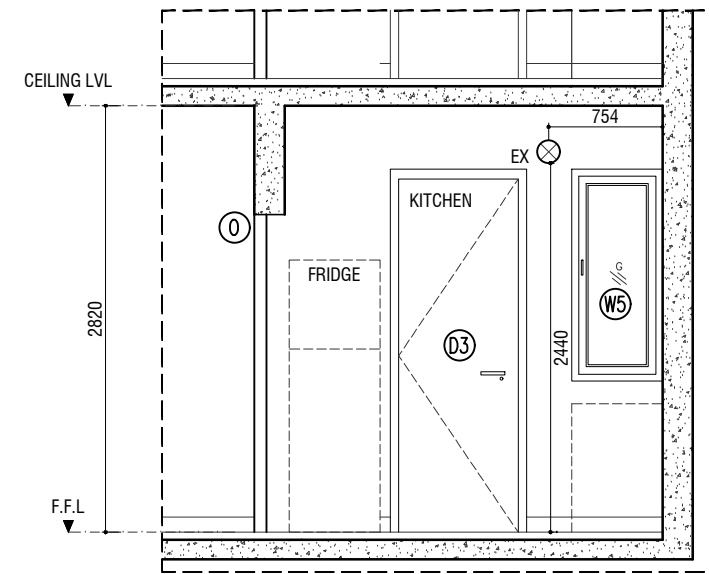

ELEVATION 2

LEGEND		
SYMBOL	DESCRIPTION	MOUNTING HEIGHT
LS	LIGHT SWITCH	1150 mm
PS	13A SWITCH SOCKET- GENERAL PURPOSE	1150 mm
16A	16A SWITCH SOCKET - OVEN	450 mm
H	16A SWITCH SOCKET- HOOD	1750 mm
F	13A SWITCH SOCKET - FRIDGE	1150 mm
○	SURFACE MOUNTED LIGHT	-
EX	150mm Ø HOOD EXHAUST	2100 mm

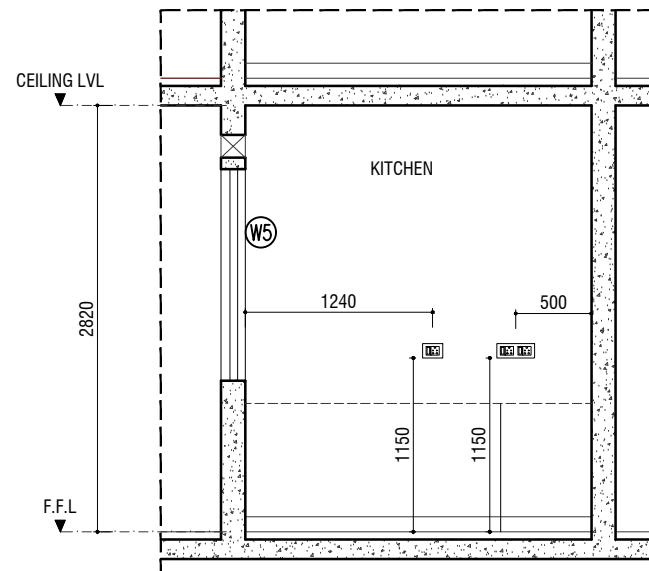

ELEVATION 3

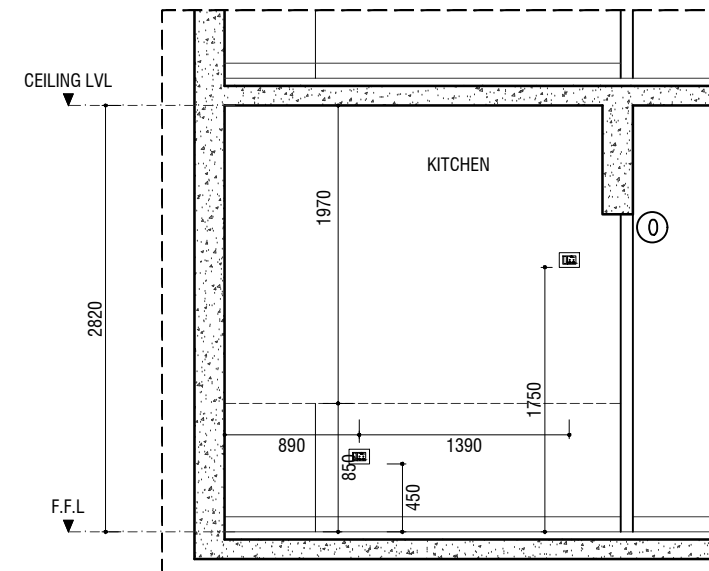

ELEVATION 4

KPIL 3BHK TYPE B KITCHEN LAYOUT

SCALE 1:50

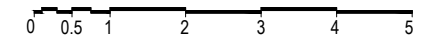

Sheet No.

A-02

2 / 6

CLIENT:
 FAHI DHIRIULHUN CORPORATION

PROJECT:
 4000 HOUSING UNITS
 KITCHEN LAYOUT

DEVELOPER:

CONSULTANT:

REVISION :

ARCHITECT

ENGINEER

DRAFT BY
 ASJAD MOHAMED
CHECKED BY
 HUSSAIN AZEEM

STAMP:

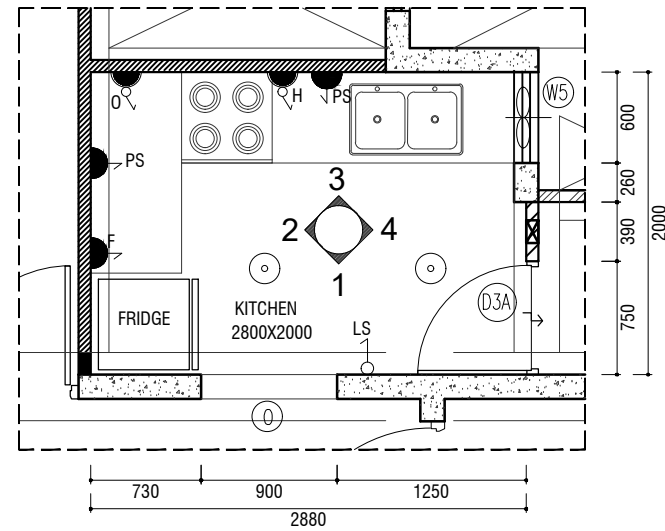

KITCHEN PART PLAN

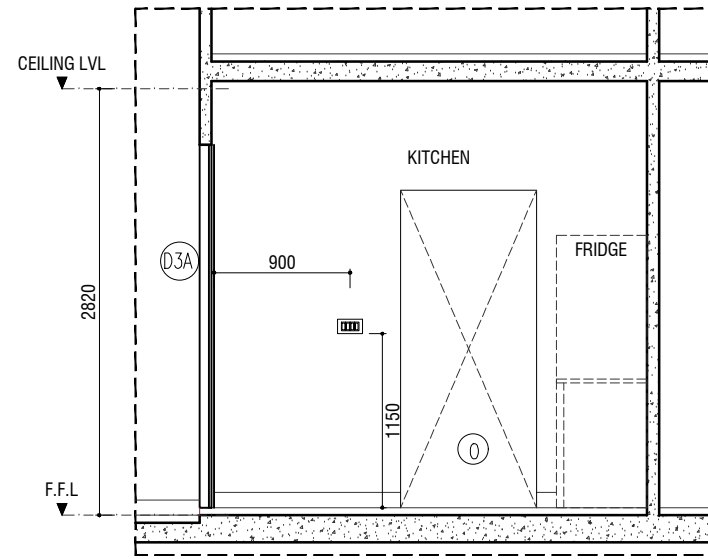

ELEVATION -1

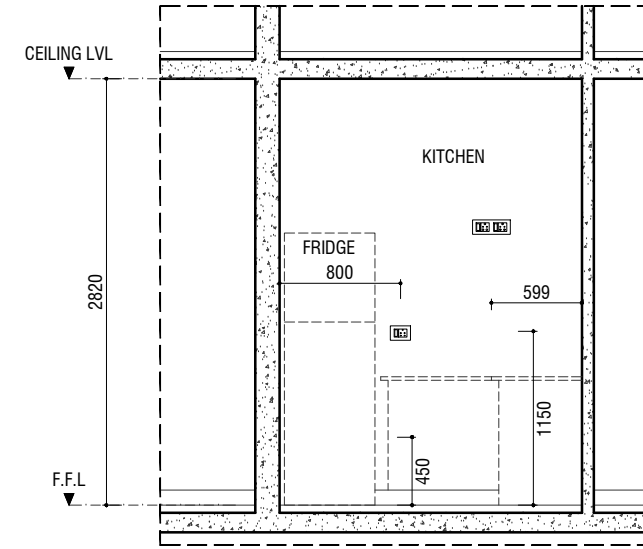

ELEVATION -2

LEGEND		
SYMBOL	DESCRIPTION	MOUNTING HEIGHT
LS	LIGHT SWITCH	1150 mm
PS	13A SWITCH SOCKET- GENERAL PURPOSE	1150 mm
O	16A SWITCH SOCKET - OVEN	450 mm
H	16A SWITCH SOCKET- HOOD	1750 mm
F	13A SWITCH SOCKET - FRIDGE	1150 mm
○	SURFACE MOUNTED LIGHT	-
EX	150mm Ø HOOD EXHAUST	2100 mm

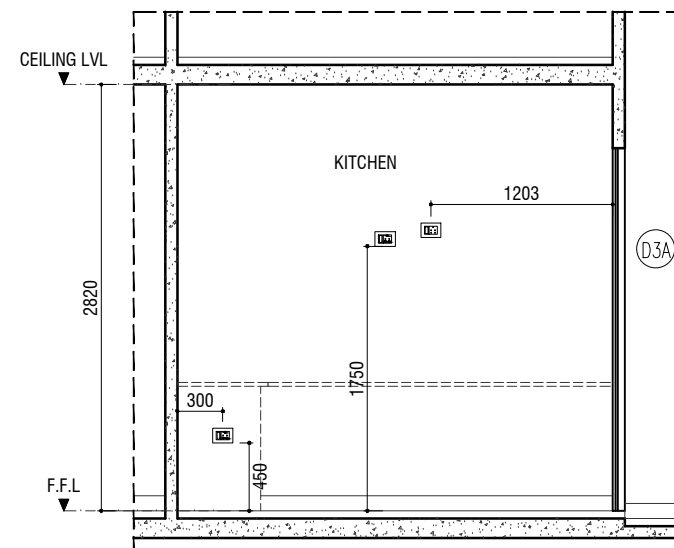

ELEVATION -3

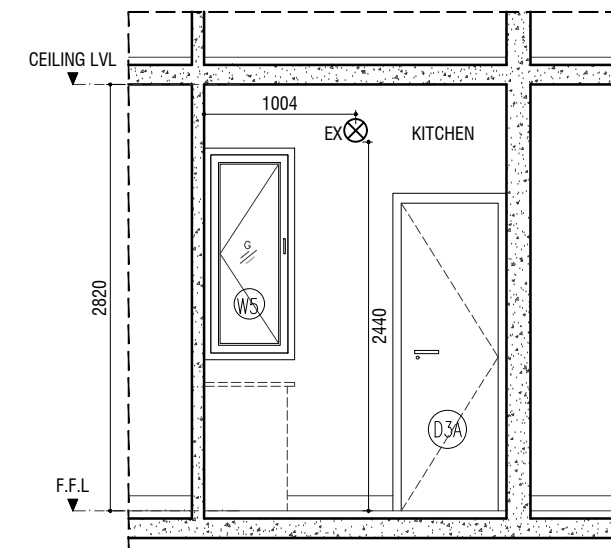

ELEVATION -4

KPIL 2BHK TYPE A KITCHEN LAYOUT

SCALE 1:50

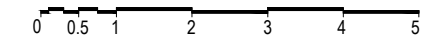

Sheet No.

A-03

3 / 6

CLIENT:
 FAHI DHIRIULHUN CORPORATION

PROJECT:
 4000 HOUSING UNITS
 KITCHEN LAYOUT

DEVELOPER:

CONSULTANT:

REVISION :

ARCHITECT

ENGINEER

DRAFT BY
 ASJAD MOHAMED
CHECKED BY
 HUSSAIN AZEEM

STAMP:

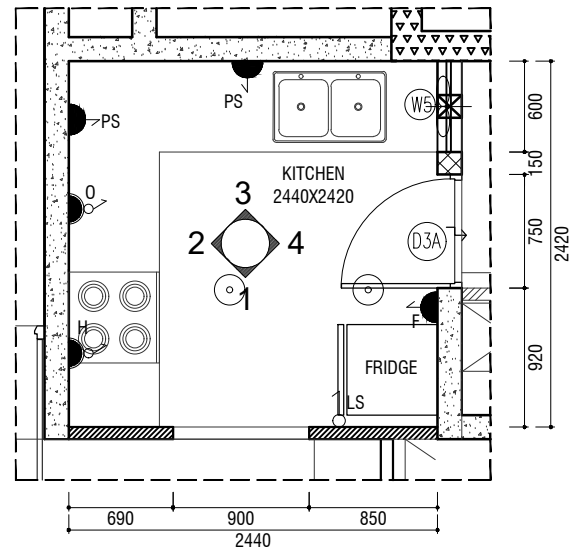

KITCHEN PART PLAN

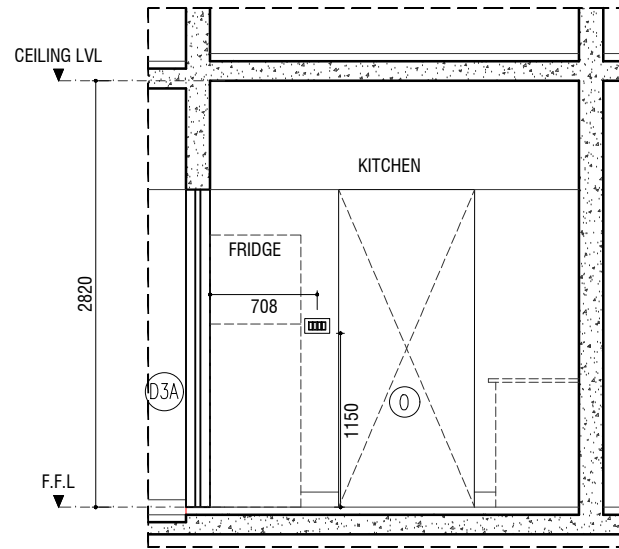

ELEVATION -1

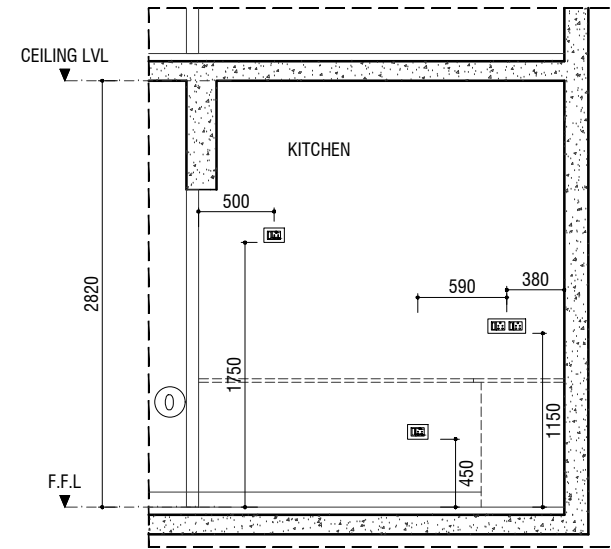

ELEVATION -2

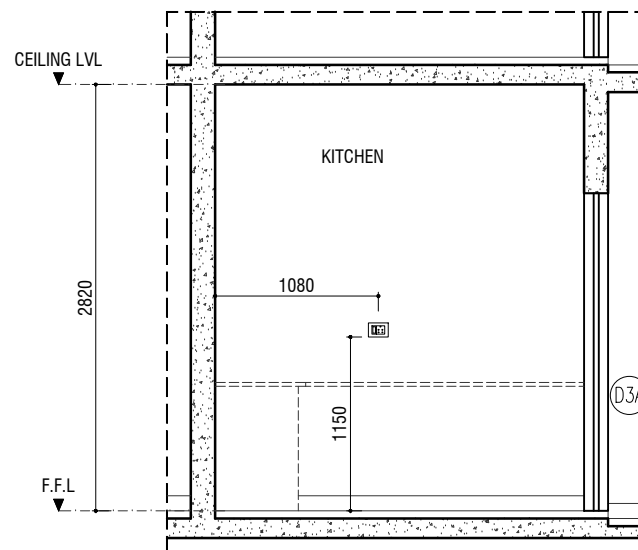

ELEVATION -3

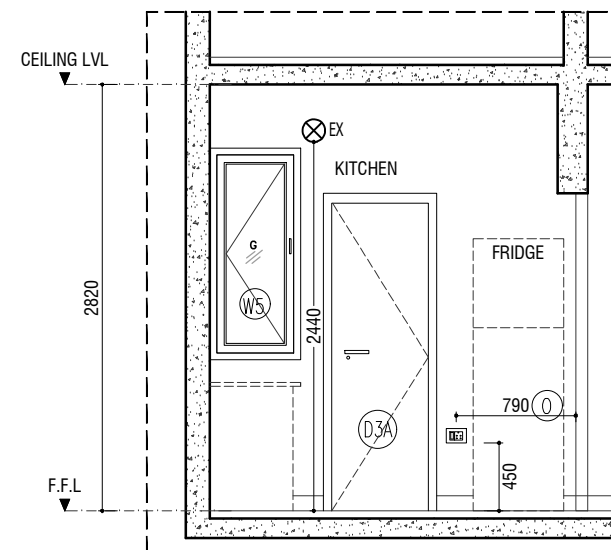

ELEVATION -4

LEGEND		
SYMBOL	DESCRIPTION	MOUNTING HEIGHT
LS	LIGHT SWITCH	1150 mm
PS	13A SWITCH SOCKET- GENERAL PURPOSE	1150 mm
O	16A SWITCH SOCKET - OVEN	450 mm
H	16A SWITCH SOCKET- HOOD	1750 mm
F	13A SWITCH SOCKET - FRIDGE	1150 mm
○	SURFACE MOUNTED LIGHT	-
EX	150mm Ø HOOD EXHAUST	2100 mm

KPIL 2BHK TYPE B KITCHEN LAYOUT

SCALE 1:50

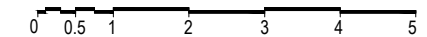

Sheet No.

A-04

4 / 6

CLIENT:
 FAHI DHIRIULHUN CORPORATION

PROJECT:
 4000 HOUSING UNITS
 KITCHEN LAYOUT

DEVELOPER:

CONSULTANT:

REVISION :

ARCHITECT

ENGINEER

DRAFT BY
 ASJAD MOHAMED
CHECKED BY
 HUSSAIN AZEEM

STAMP:

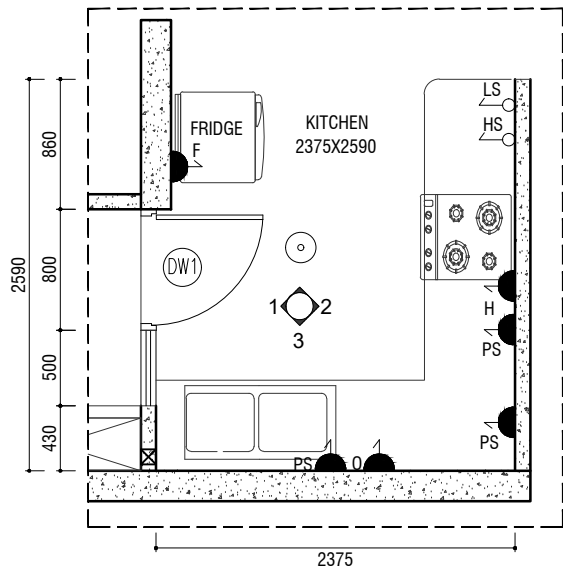

KITCHEN PART PLAN

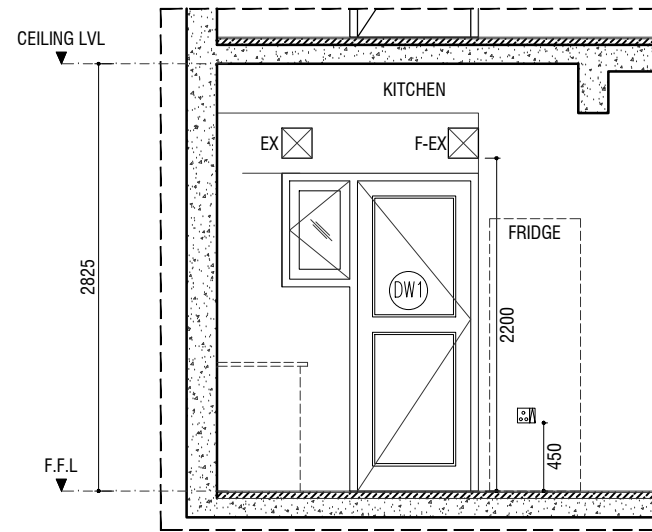

ELEVATION 1

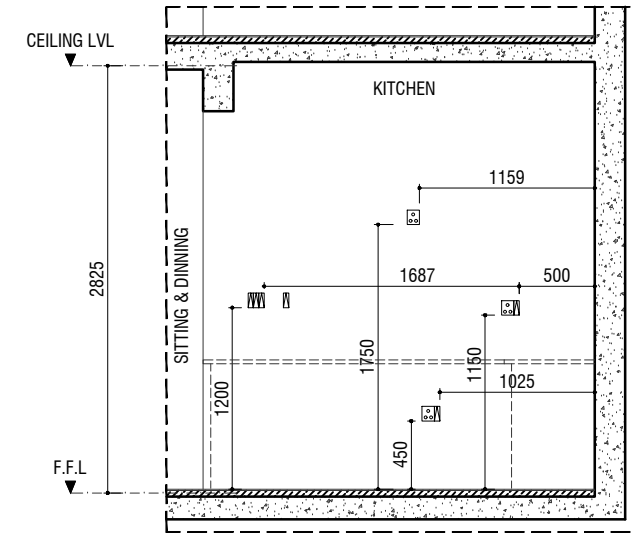

ELEVATION 2

LEGEND		
SYMBOL	DESCRIPTION	MOUNTING HEIGHT
LS	LIGHT SWITCH	1150 mm
HS	15A SWITCH = HOOD	1150 mm
PS	13A SWITCH SOCKET- GENERAL PURPOSE	1150 mm
O	16A SWITCH SOCKET- OVEN	450 mm
H	16A SWITCH SOCKET- HOOD	1750 mm
F	13A SWITCH SOCKET- FRIDGE	1150 mm
○	SURFACE MOUNTED LIGHT	-
EX	200X200 MM HOOD EXHAUST	2200 mm
F-EX	200X200 MM EXHAUST FAN	2200 mm

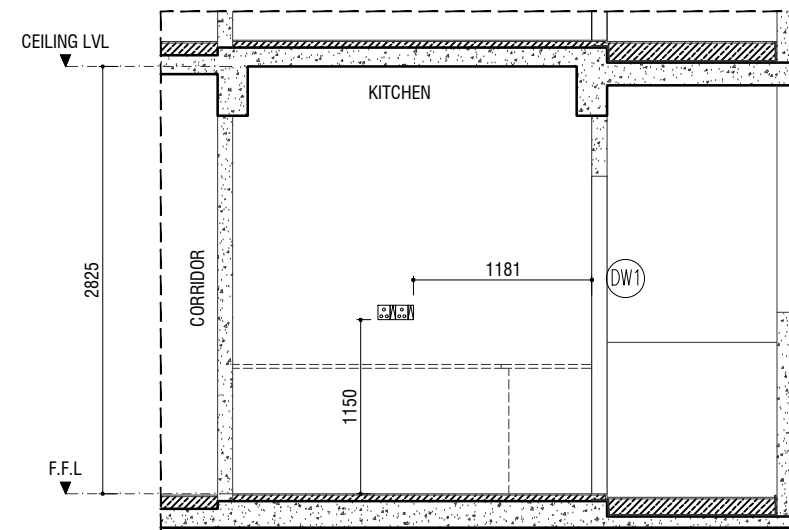

ELEVATION 3

NBCC 2BHK KITCHEN LAYOUT

SCALE 1:50

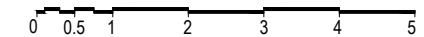

Sheet No.

A-05

5 / 6

CLIENT:
FAHI DHIRIULHUN CORPORATION

PROJECT:
4000 HOUSING UNITS
KITCHEN LAYOUT

DEVELOPER:

CONSULTANT:

REVISION :

ARCHITECT

ENGINEER

DRAFT BY
ASJAD MOHAMED
CHECKED BY
HUSSAIN AZEEM

STAMP:

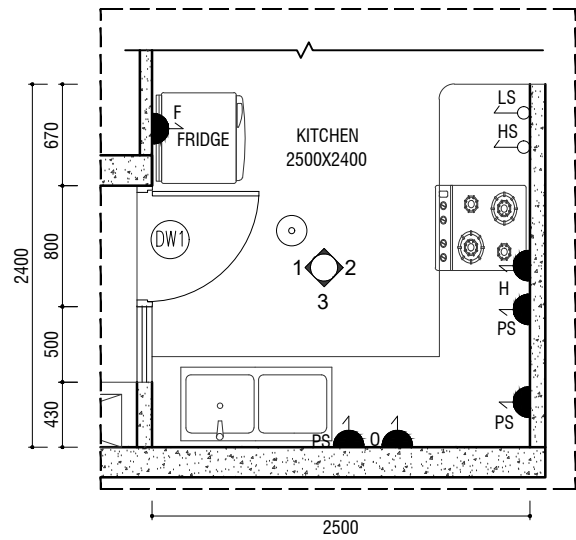

KITCHEN PART PLAN

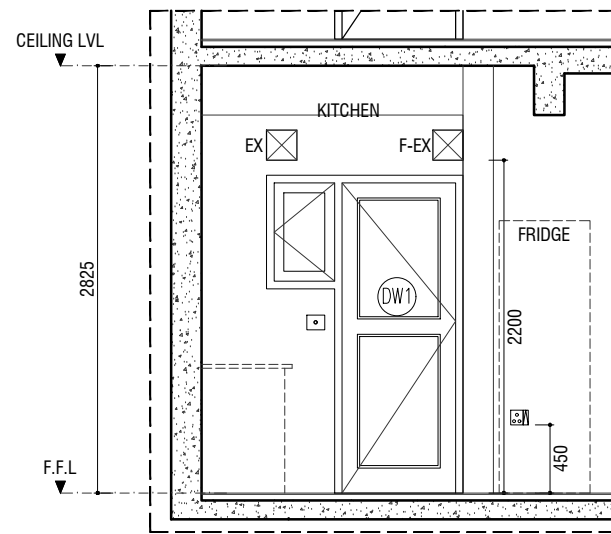

ELEVATION 1

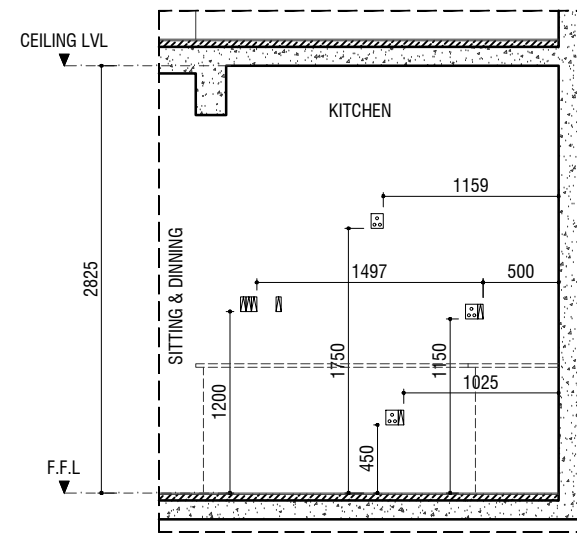

ELEVATION 2

LEGEND		
SYMBOL	DESCRIPTION	MOUNTING HEIGHT
LS	LIGHT SWITCH	1150 mm
HS	15A SWITCH =HOOD	1150 mm
PS	13A SWITCH SOCKET- GENERAL PURPOSE	1150 mm
O	16A SWITCH SOCKET- OVEN	450 mm
H	16A SWITCH SOCKET- HOOD	1750 mm
F	13A SWITCH SOCKET- FRIDGE	1150 mm
○	SURFACE MOUNTED LIGHT	-
EX	200X200 MM HOOD EXHAUST	2200 mm
F-EX	200X200 MM EXHAUST FAN	2200 mm

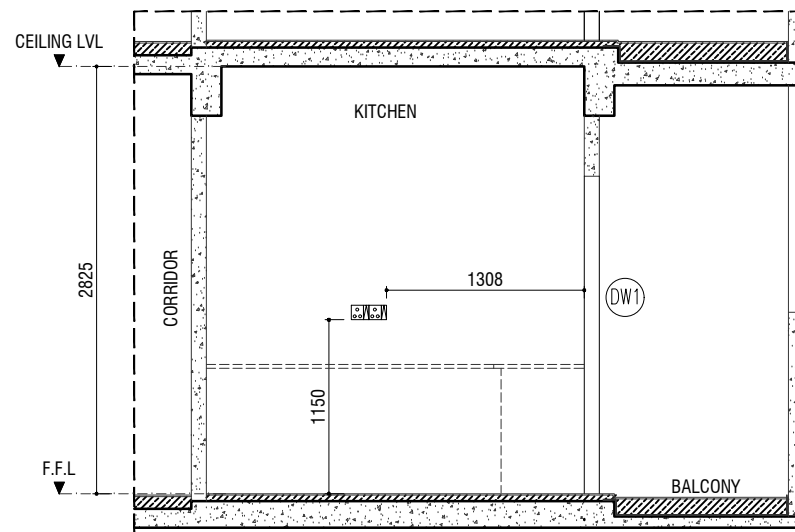

ELEVATION 3

NBCC 3BHK KITCHEN LAYOUT

SCALE 1:50

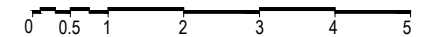

Sheet No.

A-06

6 / 6

Ref No: (IUL)FDC-BD/FDC/2024/13

EXPRESSION OF INTEREST (EOI) APPLICATION FORM

BUSINESS INFORMATION	
Business Name	
Business Registration Number	
Correspondence Address	
Registered Address	
Date of Registration	
Name of Representative	
Designation of Representative	
Contact Number	
Email Address	

BUSINESS DETAILS	
Business Sector	
Goods and services offered	
No. of Employees	
Current Business Operations <i>(No. of Outlets currently in operation)</i>	



DETAILS OF THE PROPOSAL	
Title of the Proposal/EOI Ref. No.	
Summary of the Proposal	
Objectives of the Proposal	
Proposed Business Model and Terms	
Partnership details and Collaboration Details <i>Outline proposed partnership and collaboration arrangements with other organizations in the delivery of the proposed project (if relevant)</i>	
PROPOSED FINANCIAL DETAILS	
Total Investment (MVR/USD)	
Proposed financing structure for the Project: <i>Equity Capital, Term Loan, External Commercial Borrowings, or any other source</i>	



REQUIRED DOCUMENT FOR FDC's DUE DILIGENCE COMPLIANCE			
SECTION A – Information of Business		Applicant	FDC
A-1	Business Registration Certificate		
A-2	Company Profile		
	- List of all major shareholders		
	- List of key directors of the company		
A-3	Memorandum of Association		
A-4	Articles of Association		
SECTION B – Financial Documents		Applicant	FDC
B-1	Audited Financial Statement of the past 3 years		
B-2	Documents validating the financial capacity of Proponent to deliver the project		
Section C: Experience		Applicant	FDC
C-1	Information on past projects undertaken by the Proponent		
C-2	Project completion certificate		
C-3	Reference letter		
C-4	Proof of operation		



DECLARATION

By submitting:

I/we hereby apply for Expression of Interest and by confirming below, I/we agree, represent and warrant that:

1. All information provided in/with this application is true and correct and I/we authorize FDC to verify this information.
2. I/We understand that the processing of this EOI application will take a reasonable period and is subject to the evaluation criteria and standard of approval process of the FDC.
3. I/We further understand that the acceptance of this application is at the sole discretion of FDC and FDC reserves the right to reject this application if this application is in contradiction to the above.

Authorized Signatory

Company Stamp

Sign:

Full Name:

Designation:

Date:



FORM 1: DECLARATION OF PENDING OR THREATENED LITIGATIONS

Fahi Dhiriulhun Corporation Limited

6th Floor, Maldives Post Building,
Boduthakurufaanu Magu, 20026,
Malé, Republic of Maldives

(Date)

Dear Sir/Madam,

Proposal Name:

Re: Declaration of Pending or Threatened Litigations

The following is a list of all ongoing litigation, suits, proceedings, investigations, adjudications, arbitrations, and governmental proceedings in which the proponent or any of its directors is, or is likely to be, a party, or which is threatened against any of them, or for which there are ongoing responsibilities of any of them.

No.	Claimant	Defendant	Type of Claim	Amount

I hereby declare that, except for the above, there is no action, suit, proceeding, investigation, adjudication, arbitration, or litigation pending or, to the knowledge of the proponent, threatened, which, in any instance or in the aggregate, if determined adversely to the proponent, would materially and adversely affect the execution or progression of the business operation or the proponent's ability to perform its obligations under the Agreement/Contract for the investment or operation of the business.

I hereby declare under penalty of perjury that the foregoing is true and correct.

Yours sincerely,

(Name of signatory)

(Title)

Note: This document is required to be notarized and sealed by a registered Notary Public.



FORM 2: DECLARATION OF NO PENDING LITIGATION

Fahi Dhiriulhun Corporation Limited

6th Floor, Maldives Post Building,
Boduthakurufaanu Magu, 20026,
Malé, Republic of Maldives

(Date)

Dear Sir/Madam,

Proposal Name:

Re: Declaration of No Pending Litigation

I hereby declare that there is no action, suit, proceeding, investigation, or litigation pending or, to the knowledge of the proponent, threatened, which, either in any one instance or in the aggregate, if determined adversely to the proponent, would materially and adversely affect the execution or progression of the business operation or the proponent's ability to perform its obligations under the Agreement/Contract for the investment or operation of the business.

I hereby declare under the penalty of perjury that the foregoing is true and correct.

Yours sincerely,

(Name of signatory)

(Title)

Note: This document is required to be notarized and sealed by a registered Notary Public.



FORM 3: DECLARATION OF IMMEDIATE FAMILY MEMBERS

Date: _____

Business Name: _____

Business Registration Number: _____

Name and contact of responsible person: _____

We, **[insert business name and business registry number]**, hereby confirm and declare the following:
There is a relationship (immediate family members employed at FDC) that places us in a position to influence the proponent’s proposal or affect the Lessor’s decisions regarding the EOI process. **(Yes/No)**

If **YES**, please provide the relevant details below.

Details of the person applying for declaration		Details of the FDC Staff			
Name	Designation	NID No.	Family member/ Relatives Name	Relationship	Position/Title

The information above is true, accurate and if all or any part of it is found to be untrue, FDC shall have the right to disqualify and reject the proposal or terminate the agreement/work order.

We are also obliged to inform and disclose to FDC if there are any changes to the declaration herein, within ten (10) days of the occurrence of such changes.

Yours sincerely,

Signature & Company Stamp
(Name of the Authorized Signatory)
(Designation of the Authorized Signatory)



DUE DILIGENCE AND SELECTION PROCESS

STAGE 1 – DOCUMENT CHECK AND ELIGIBILITY

- FDC will check and verify the documents required are submitted by the Applicant. Further the applicant shall meet the criteria stated in the announcement details where applicable.

STAGE 2 – EVALUATION

- Applicants that fulfil the requirements in Stage 1 shall be evaluated based on the specific evaluation criteria, which will be provided in the EOI announcements for a specific scope. This does not apply if the application is not specific to a particular EOI announcement.

STAGE 3 – NEGOTIATIONS (IF REQUIRED)

- FDC shall propose the minimum terms and conditions for the proposed collaboration.

STAGE 4 – APPROVAL

- Once the terms and condition has been accepted by proponent, the proposal and accompanying documents will be forwarded to FDC’s Management for endorsement.

STAGE 5 – CONDITIONAL AWARD/MOU

- Upon endorsement by FDC, the collaboration will be conditionally awarded to the Proponent, subject to the fulfilment of specific conditions outlined in the conditional award. These conditions must be met within the timeframe set by FDC.
- In certain cases, FDC may enter a Memorandum of Understanding (MOU) with the Proponent, outlining the intent and key terms of the partnership. The MOU will be subject to the Proponent meeting the agreed-upon conditions within the specified timeframe.

STAGE 6 – MOU SIGNING

- Upon notification of the conditional award or MOU, FDC will send the successful Proponent the relevant Agreement or MOU.
- For Conditional Award, within seven (7) days of fulfilling the conditions outlined in the award, the Proponent shall sign the Agreement with FDC.
- For MOU, the Proponent shall sign the MOU with FDC within seven (7) days of meeting the conditions outlined in the MOU.
- Failure to meet the conditions or to sign the Agreement or MOU within the stipulated period will result in the annulment of the conditional award or MOU.